

ADDRESS EAST



— WE ARE DORRA

For over 70 years Dorra Group has been building and developing the Egyptian real estate landscape and laying down the tarmac for the growth of the real estate industry we see today.

Pioneers in the construction, development and tourism fields, Dorra Group has witnessed a change in the Egyptian economic, social and governing bodies since 1943 and have continued to change and adapt with the market.

Continually striving to develop their communities, Dorra Group today spearheaded by Dorra Developments have entered a new epoch in providing residential and mixed use projects to the market place that is masterfully constructed, finished and designed as well as maintained and serviced throughout.

—YOUR ADDRESS EAST

Developed over 60 acres, The Address East induced to the market a volume of 1200 fully finished apartments, duplexes, twin houses and separate villas.

Apartments size ranging from 121 m² up to 180 m², duplex 210 m², twin house 315 m². Address East is the perfect choice for a newly married couple.

Moreover, families that looking for tranquility and luxurious standards, all their expectations will be amazingly and professionally met.

Address East is definitely your new home.

—THE ADDRESS LIFE



THE RETAIL STRIP



UFC GYM



CLUB HOUSE



RESTAURANTS



SPA



ZEN GARDENS



JOGGING TRACK



KIDS AREA



UNDERGROUND PARKING



SURVEILLANCE SYSTEM

—EAST CLUB HOUSE

Positioned at the heart of Address East, East Club House has been designed by award winning interior designers to offer that extra sense of exclusivity and heightened experience.

Open to all tenants of Address East and their visitors, The East Club House will provide the convenience, service and comfort of your home yet set in a leisure and modern ambience.



— UFC

Over 3,000 m2 at East Strip, the UFC Gym will assume 3 floors of the latest advancements in cardio and muscle defining machinery as well as grappling bars and MMA training for those looking to pursue the high contact sport leisurely or professionally.

UFC will be the second branch in Egypt opening up yet it will be the first branch to open in the east of Cairo.

—EAST SPA

Privately nestled away at the UFC gym, is our EastSpa retreat, specially designed to mirror the ambience and imagery of the east of Cairo area that we have envisioned for the future. Managed by a leading spa and health provider, we will ensure that your experience at Address East will be that extra bit more special.

—ZEN GARDENS

Inspired by the art and placement of FengShui, Address East will be a home to some of the most inspiring, relaxing and mediation centric gardens and open areas in the east of Cairo, we know how to harmonize you with our inspirational surroundings.

—EAST STRIP: CAFÉS AND EATERIES

Neatly aligned on East Strip, we have hand picked some of the most sought after cafes and restaurants in Cairo and have brought them to Address East, where dining experiences, casual encounters and that precious alone time can be spent only steps away from your residence.

—WELCOME HOME

Address East is located within the urban suburbs of East Cairo, only 5 minutes away with direct access from the main Suez road.

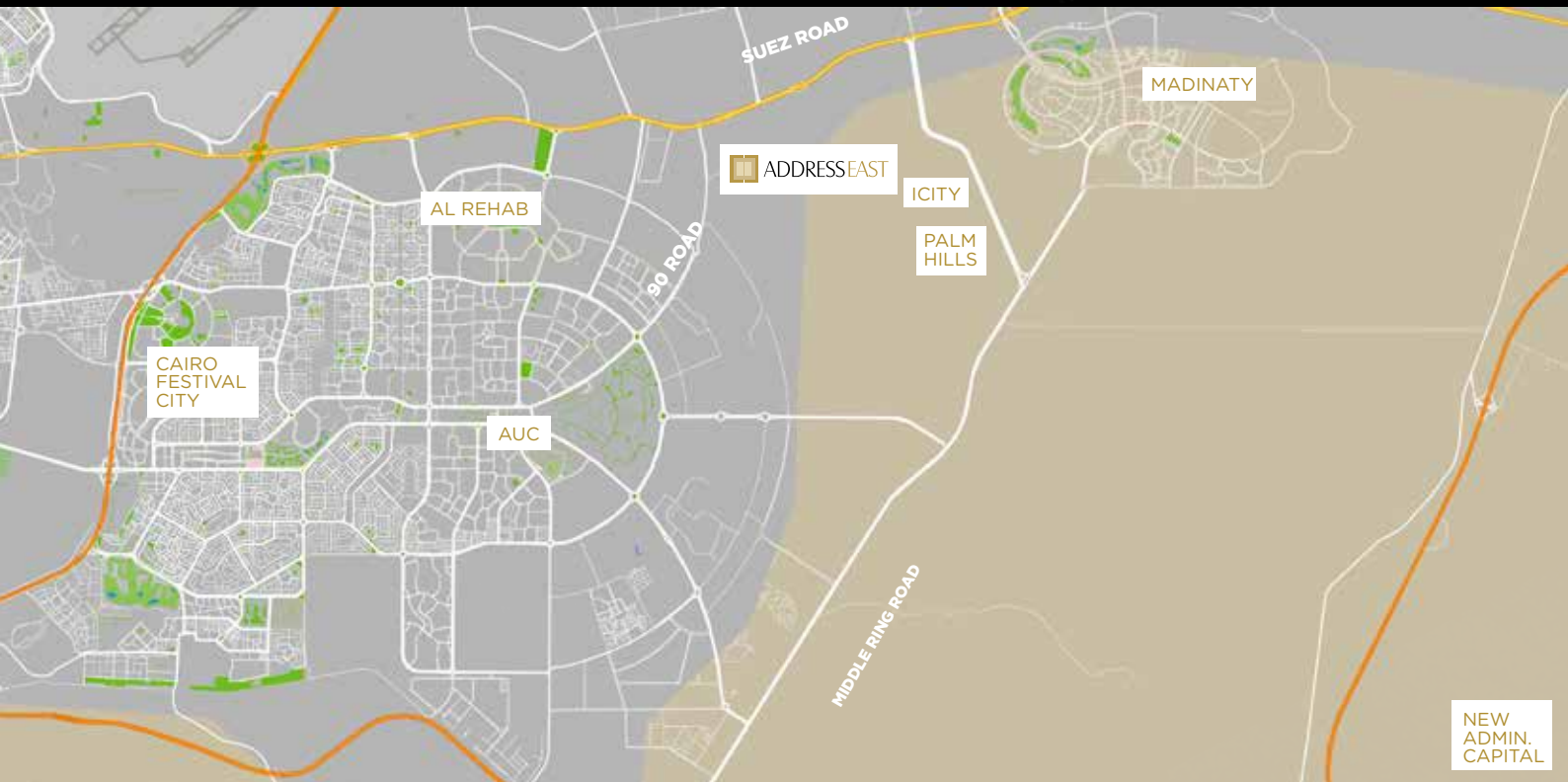

- 10 minutes away from AUC
- 20 minutes away from Heliopolis and Nasr City
- 15 minutes away from Cairo Airport
- 5 minutes away from New Administrative Capital
- 0 minutes away from your dream

—THE PROJECT

A contemporary and modern design, incorporating aesthetically pleasing architectural structures that are subtly influenced with a modern arabesque flair.

Address East will provide the luxurious and exclusive comforts for our community to reside in amidst a tranquil environment. Our fully finished apartments and duplex's have been meticulously designed to meet and exceed expectations.



—THE PROJECT



—THE PROJECT



—INTERIORS



—MASTER PLAN

- 1,748 units comprising of 88 apartment building, 24 twin houses and 8 Limited detached villas.
- 60 acres.
- 80% of development devoted to common areas and private gardens.
- East Strip



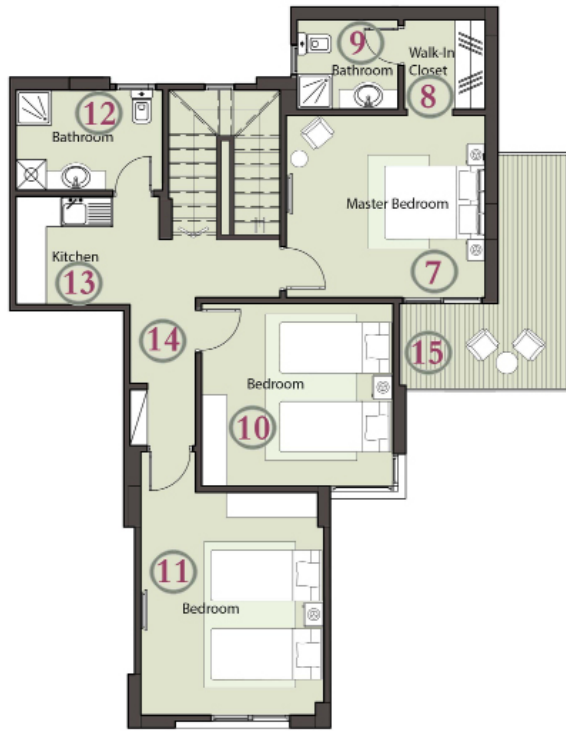

FIRST FLOOR



GROUND FLOOR

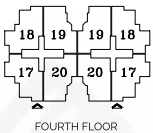

FOURTH FLOOR

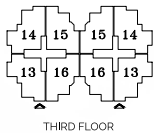

THIRD FLOOR

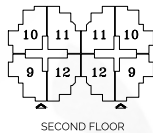

SECOND FLOOR

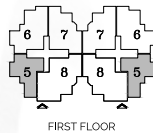

FIRST FLOOR

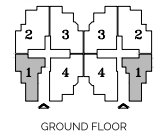

GROUND FLOOR

| | |
|--------------------|--|
| 01- Reception | 3.72x4.98 m ² |
| 02- Living | 3.70x4.52 m ² |
| 03- Dining | 3.60x6.25 m ² |
| 04- Kitchen | 1.64/2.90x2.70/4.72 m ² |
| 05- Guest Toilet | 1.77x3.72 m ² |
| 06- Terrace | 1.11x3.83 m ² |
| 07- Master Bedroom | 3.60x3.93 m ² |
| 08- Walk-In Closet | 1.60x1.77 m ² |
| 09- Bathroom | 1.77x2.00 m ² |
| 10- Bedroom 1 | 3.60x3.78 m ² |
| 11- Bedroom 2 | 3.61x4.40 m ² |
| 12- Bathroom | 2.00x2.90 m ² |
| 13- Kitchenette | 2.14x2.83 m ² |
| 14- Corridor | (1.14x2.39)/(1.33x2.98) m ² |
| 15- Terrace | (1.73x3.41)/(1.47x2.94) m ² |

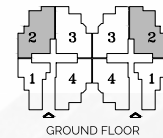
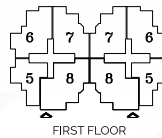
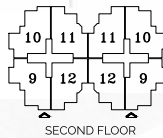
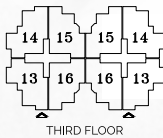
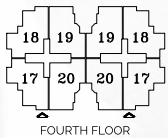

| | |
|--------------------------|------------------------------|
| 01- Reception and Dining | 3.60x7.18 m ² |
| 02- Kitchen | 2.13/2.9x4.24 m ² |
| 03- Master Bedroom | 3.60x3.93 m ² |
| 04- Bathroom | 1.77x2.00 m ² |
| 05- Walk-In Closet | 1.60x1.77 m ² |
| 06- Bedroom 1 | 3.60x3.78 m ² |
| 07- Bedroom 2 | 3.61x4.40 m ² |
| 08- Bathroom | 2.20x2.83 m ² |
| 09- Corridor 1 | 1.30x2.92 m ² |
| 10- Corridor 2 | 1.15x2.97 m ² |
| 11- Terrace | 1.97x3.81 m ² |
| 12- Terrace | 1.73x1.94 m ² |

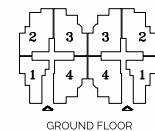
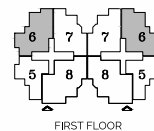
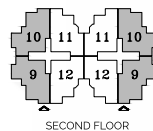
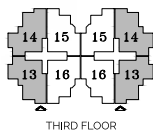
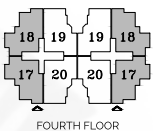

| | |
|--------------------------|--|
| 01- Reception and Dining | 3.60x7.18 m ² |
| 02- Kitchen | 2.13/2.9x4.24 m ² |
| 03- Master Bedroom | 3.60x3.93 m ² |
| 04- Bathroom | 1.77x2.00 m ² |
| 05- Walk-In Closet | 1.60x1.77 m ² |
| 06- Bedroom 1 | 3.60x3.78 m ² |
| 07- Bedroom 2 | 3.61x4.40 m ² |
| 08- Bathroom | 2.20x2.83 m ² |
| 09- Corridor 1 | 1.30x2.92 m ² |
| 10- Corridor 2 | 1.15x2.97 m ² |
| 11- Terrace | 1.97x3.81 m ² |
| 12- Terrace | (1.73x1.94)+(1.42x4.72) m ² |

BUILDING TYPE 1

140 M²

ADDRESS EAST

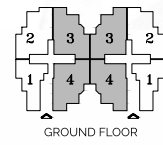
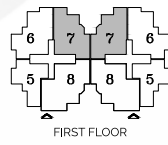
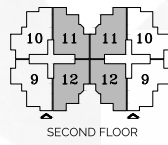
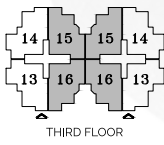
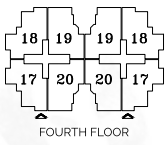

| | |
|--------------------------|--------------------------|
| 01- Reception and Dining | 3.60x7.18 m ² |
| 02- Kitchen | 2.83x3.82 m ² |
| 03- Master Bedroom | 3.60x3.93 m ² |
| 04- Bathroom | 1.77x2.21 m ² |
| 05- Walk-In Closet | 1.60x1.77 m ² |
| 06- Bedroom 1 | 3.60x3.78 m ² |
| 07- Bedroom 2 | 3.60x3.61 m ² |
| 08- Bathroom | 2.30x2.83 m ² |
| 09- Corridor 1 | 1.30x2.92 m ² |
| 10- Corridor 2 | 1.30x6.11 m ² |
| 11- Terrace | 1.56x1.73 m ² |
| 12- Terrace | 1.97x3.80 m ² |

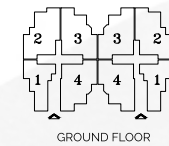
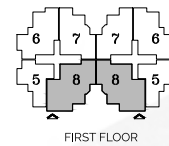
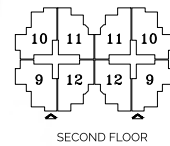
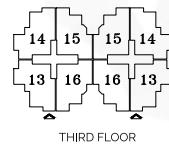
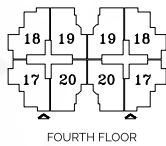

| | |
|----------------------------------|--------------------------|
| 01- Reception, Living and Dining | 7.18x7.88 m ² |
| 02- Kitchen | 2.83x3.82 m ² |
| 03- Master Bedroom | 3.60x3.93 m ² |
| 04- Bathroom | 1.77x2.21 m ² |
| 05- Walk-In Closet | 1.60x1.77 m ² |
| 06- Bedroom 1 | 3.60x3.78 m ² |
| 07- Bedroom 2 | 3.60x3.61 m ² |
| 08- Bathroom | 2.30x2.83 m ² |
| 09- Corridor 1 | 1.30x2.92 m ² |
| 10- Corridor 2 | 1.30x6.11 m ² |
| 11- Terrace | 1.57x1.73 m ² |
| 12- Terrace | 1.97x7.86 m ² |

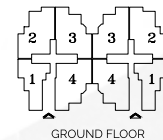
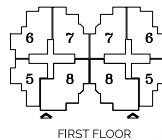
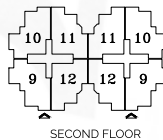
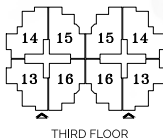
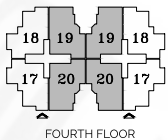

| | |
|--------------------------|--------------------------|
| 01- Reception and Dining | 3.82x7.18 m ² |
| 02- Kitchen | 2.83x3.82 m ² |
| 03- Master Bedroom | 3.60x3.93 m ² |
| 04- Bathroom | 1.77x2.21 m ² |
| 05- Walk-In Closet | 1.60x1.77 m ² |
| 06- Bedroom 1 | 3.60x3.78 m ² |
| 07- Bedroom 2 | 3.60x3.61 m ² |
| 08- Bathroom | 2.30x2.83 m ² |
| 09- Corridor 1 | 1.30x2.92 m ² |
| 10- Corridor 2 | 1.30x6.11 m ² |
| 11- Terrace | 1.57x1.73 m ² |
| 12- Terrace | 1.97x7.06 m ² |

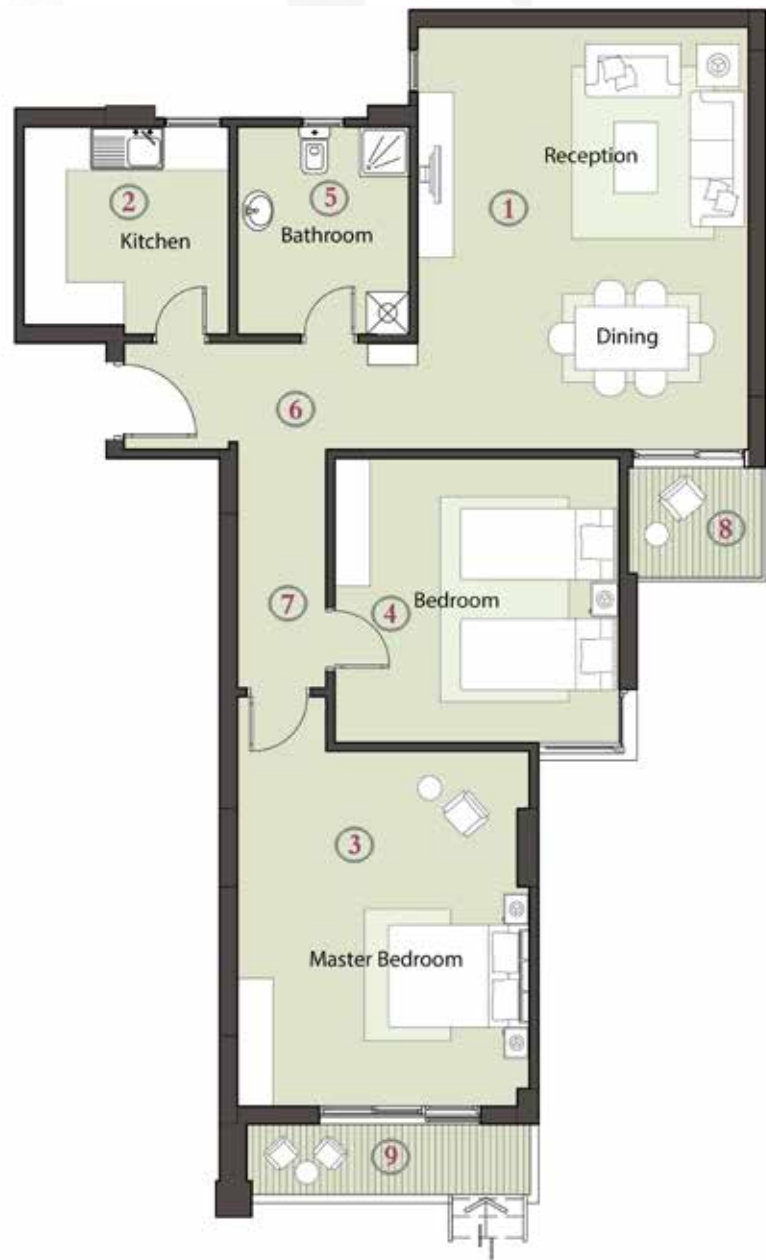

| | |
|--------------------------|--------------------------|
| 01- Reception and Dining | 4.65x5.94 m ² |
| 02- Kitchen | 2.88x2.93 m ² |
| 03- Master Bedroom | 4.10x5.00 m ² |
| 04- Bedroom 1 | 4.00x4.00 m ² |
| 05- Bathroom 2 | 2.41x2.92 m ² |
| 06- Corridor 1 | 1.50x4.13 m ² |
| 07- Corridor 2 | 1.25x3.35 m ² |
| 08- Terrace | 1.60x1.74 m ² |
| 09- Terrace | 1.11x4.11 m ² |

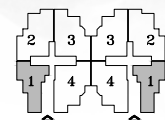
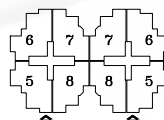
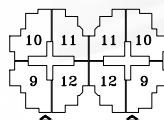
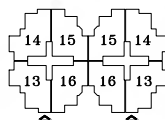
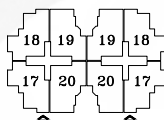

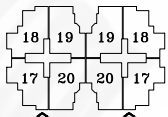

FOURTH FLOOR

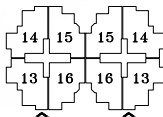

THIRD FLOOR

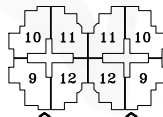

SECOND FLOOR

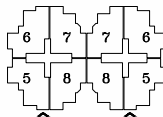

FIRST FLOOR

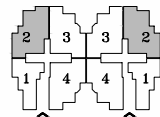

GROUND FLOOR

| | |
|--------------------------|--------------------------|
| 01- Reception and Dining | 4.00x8.10 m ² |
| 02- Kitchen | 3.14x3.48 m ² |
| 03- Master Bedroom | 4.13x4.17 m ² |
| 04- Bathroom | 1.82x2.56 m ² |
| 05- Walk-In Closet | 1.82x1.97 m ² |
| 06- Bedroom 1 | 4.00x4.00 m ² |
| 07- Bedroom 2 | 4.10x5.00 m ² |
| 08- Bathroom | 2.30x3.27 m ² |
| 09- Corridor 1 | 1.25x3.04 m ² |
| 10- Corridor 2 | 1.30*5.77 m ² |
| 11- Terrace | 1.73*1.94 m ² |
| 12- Terrace | 2.10*4.00 m ² |

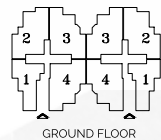
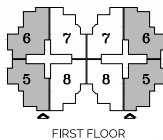
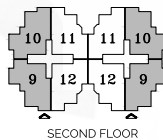
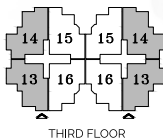
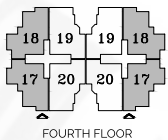

| | |
|--------------------------|--|
| 01- Reception and Dining | 4.00x8.10 m ² |
| 02- Kitchen | 3.14x3.48 m ² |
| 03- Master Bedroom | 4.00x4.17 m ² |
| 04- Bathroom | 1.82x2.56 m ² |
| 05- Walk-In Closet | 1.82x1.97 m ² |
| 06- Bedroom 1 | 4.00x4.00 m ² |
| 07- Bedroom 2 | 4.10x5.00 m ² |
| 08- Bathroom | 2.30x3.27 m ² |
| 09- Corridor 1 | 1.25x3.29 m ² |
| 10- Corridor 2 | 1.30x5.77 m ² |
| 11- Terrace | (1.47x4.72)+(1.73x1.94) m ² |
| 12- Terrace | 2.10x4.00 m ² |

**BUILDING
TYPE 2**

160 M²



| | |
|--------------------------|--------------------------|
| 01- Reception and Dining | 4.00x8.10 m ² |
| 02- Kitchen | 3.14x3.92 m ² |
| 03- Master Bedroom | 4.00x4.00 m ² |
| 04- Bathroom | 1.82x2.08 m ² |
| 05- Walk-In Closet | 1.80x1.82 m ² |
| 06- Bedroom 1 | 4.00x4.00 m ² |
| 07- Bedroom 2 | 4.00x4.10 m ² |
| 08- Bathroom | 2.30x3.27 m ² |
| 09- Corridor 1 | 1.25x3.29 m ² |
| 10- Corridor 2 | 1.30x5.77 m ² |
| 11- Terrace | 1.52x1.73 m ² |
| 12- Terrace | 2.10x4.00 m ² |

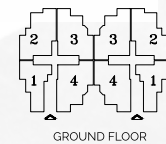
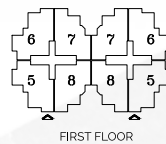
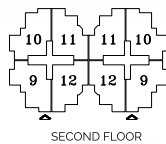
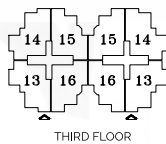
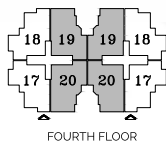

| | |
|--------------------------|--------------------------|
| 01- Reception and Dining | 4.00x8.10 m ² |
| 02- Kitchen | 3.14x3.92 m ² |
| 03- Master Bedroom | 4.00x4.00 m ² |
| 04- Bathroom | 1.81x2.08 m ² |
| 05- Walk-In Closet | 1.80x1.81 m ² |
| 06- Bedroom 1 | 4.00x4.00 m ² |
| 07- Bedroom 2 | 4.00x4.10 m ² |
| 08- Bathroom | 2.30x3.27 m ² |
| 09- Corridor 1 | 1.25x3.30 m ² |
| 10- Corridor 2 | 1.30x5.77 m ² |
| 11- Terrace | 1.52x1.73 m ² |
| 12- Terrace | 2.10x7.54 m ² |



ADDRESSEAST

☎16077

theaddresseast.com

—THE ADDRESS LIFE

